

Costume/Production Washing Information

Duties are washing costume/production clothing/set items.

After a performance

Generally washing is available for collection 24-48hours after the production has finished and has been sorted by the costume department.

If you volunteer for these duties, you will be emailed confirmation when the washing is available for pick up.

Collection

Washing is bagged, with washing instructions, generally like items together (delicates/whites/colours) and in various wash load sizes.

It is available for collection in the Ellen Street Theatre photocopy centre (located next to the Sports Hall) between 8am and 4pm. This section is open after school hours when there are Drama classes/rehearsals taking place. Please record your details when taking and returning the washing in the file adjacent to the wash bags.

Washing needs to be returned folded or on hangers provided, which helps to reduce the pressing of items and for ease of storage. Please place the 'washed' tag on the outside of the bag so it is easily identified by the costume department.

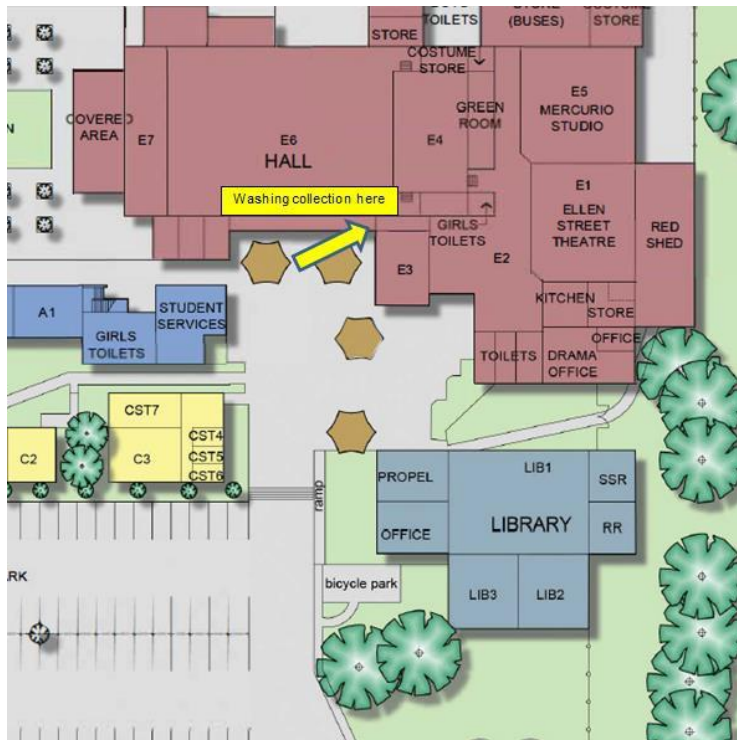

Assistance

If you have any queries or suggestions that you would like us to follow up, please do not hesitate to contact Georgia Hoad-Pipkin on 9435 0784 or via email on georgia.hoad-pipkin@education.wa.edu.au located in the Drama office in Ellen Street Theatre.